

Please follow these fixing and care instructions to ensure that your product is fitted safely and that it retains its high quality finish. Please retain this leaflet for future reference.

This instruction leaflet applies to the following products;

DG400341 - Standard Bath Plug Converta

DG400441 - Standard Basin Plug Converta

Fixing Pack/Contents

A. Converta Plug x1

B. Round Base

C. Rubber Ring

D. Securing Clip x3

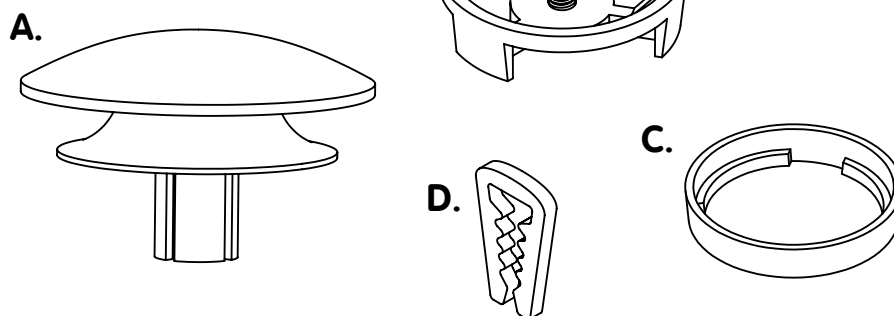

1. Before starting the installation, use the tables below and choose the most secure combination of Round Base and Rubber Ring to fit your waste. The ideal combination will be to create a tight fit inside the waste and to be flush with the surface of the waste.

Standard Bath Converta

Round Base Colour	Small Ring	Medium Ring	Large Ring
Grey	Not Required	Blue	Grey
Black	Green	Black	White

Standard Basin Converta

Round Base Colour	Small Ring	Medium Ring	Large Ring
Black	Green	Blue	Black
Grey	Green	Blue	Black

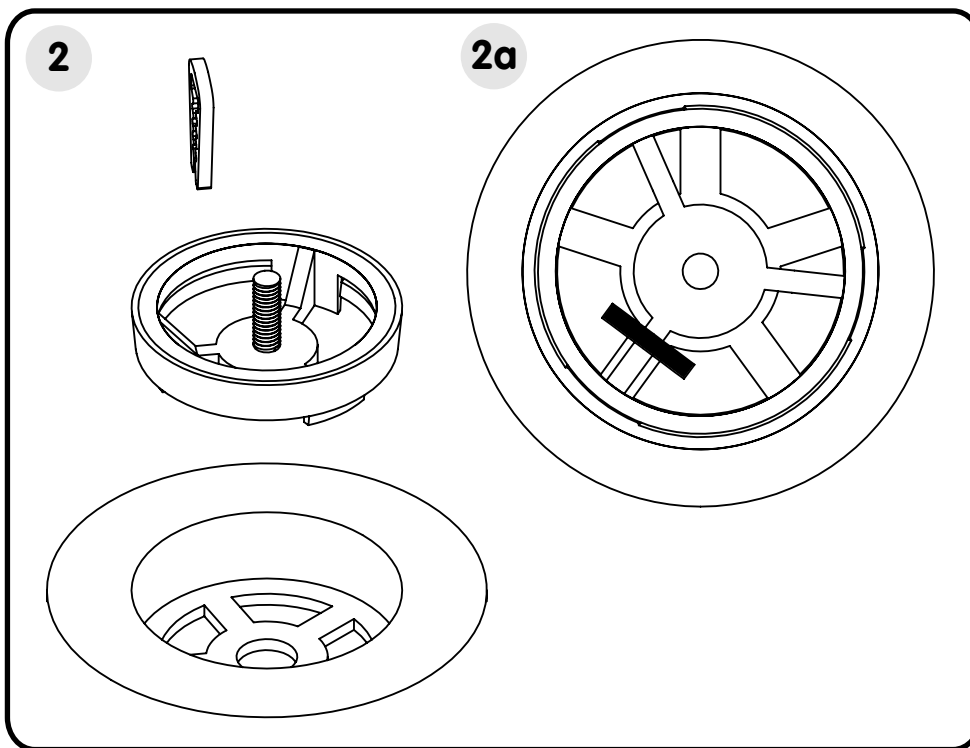

2. Once you have selected the most suitable combination of Round Base and Rubber Ring using the table in Step 1, place the Round Base into the waste and align at least one of the ribs to match up with a rung on the waste.

In **Fig 2a** you can see an example of the alignment which is required. Once the rungs are aligned push on a Securing Clip to lock the Round Base in position.

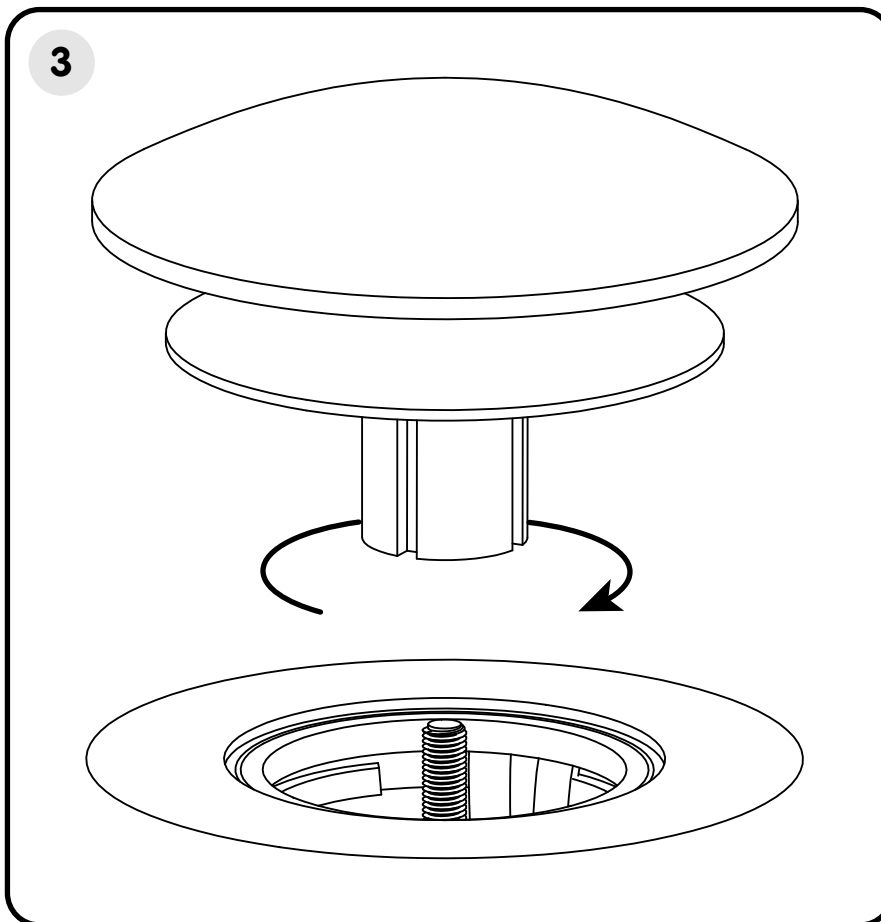

3. Fully screw the Converta Plug onto the Round Base. Click the plug a few times to test if the spring is working. Then fill up your basin or bath and test if the plug is working effectively.

Note

If the plug doesn't seal you may have to try a different Rubber Ring or alternatively you can unscrew the plug slightly.